

ARIONE
HORSE DATA SCIENCE

INSTALLATION GUIDELINES

All-in-one Girth System

How to install EQUIMETRE?

Before starting the installation of your EQUIMETRE, you must have saddled your horse as you usually do.

1 WET THE 2 ELECTRODES

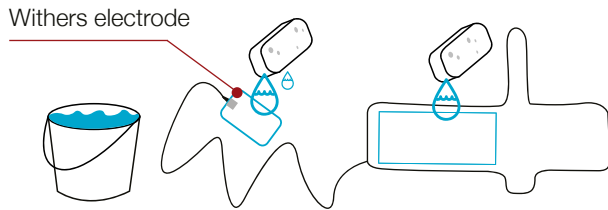

Warning : Do not drown the EQUIMETRE.

Wet the foam and the withers electrode. Equimetre should never be used without the foam.

2 TURN ON YOUR MONITOR

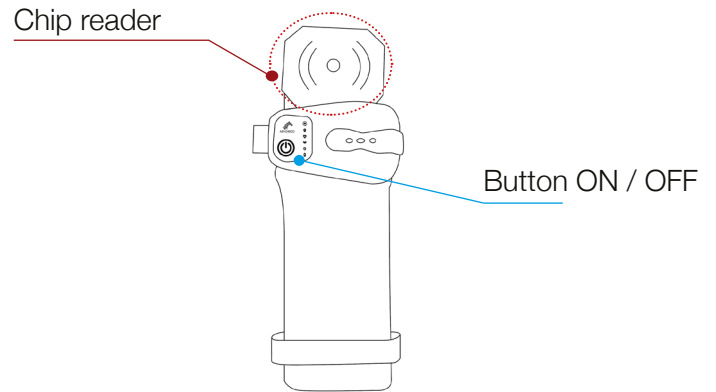

Turn on the EQUIMETRE by pressing the button once. The first white LED should blink.

3 LOOK FOR THE HORSE'S VETERINARY CHIP

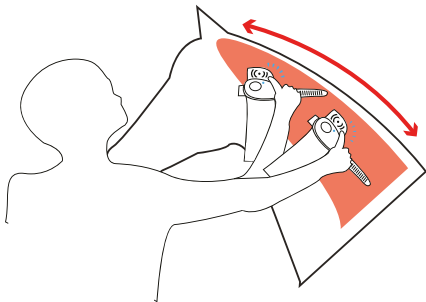

Look for your horse's veterinary chip by scanning the neck from withers to ears along the mane **SLOWLY**, until you hear a bip.

OR

Press the button 3 times to launch a training manually. You'll have to assign the horse's identity at the end of the training.

A bip sound indicates the start of the training. The first white LED should stop blinking.

4 INSTALL THE WITHERS ELECTRODE

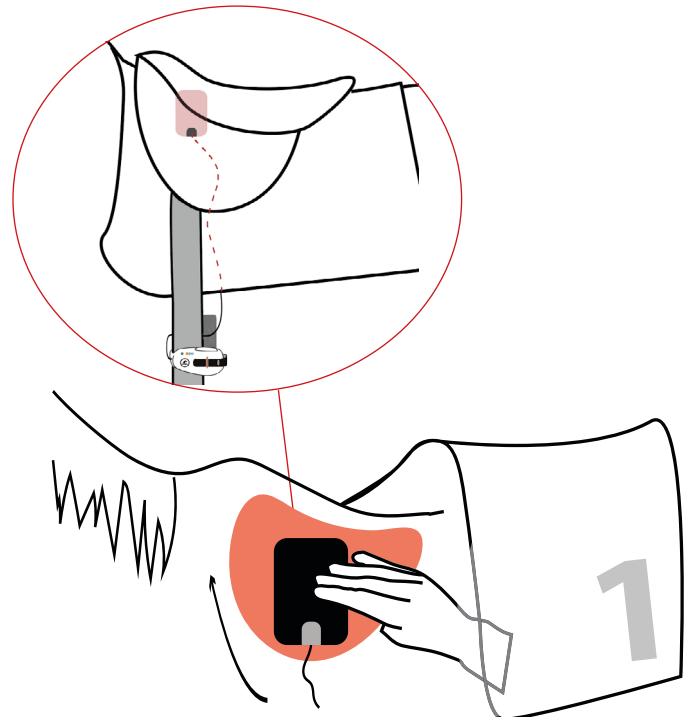

Place the withers electrode in direct contact with the horse's skin, **in the withers hollow, on the left side**, under the saddle pad.

5 PUT THE SENSOR ON THE GIRTH

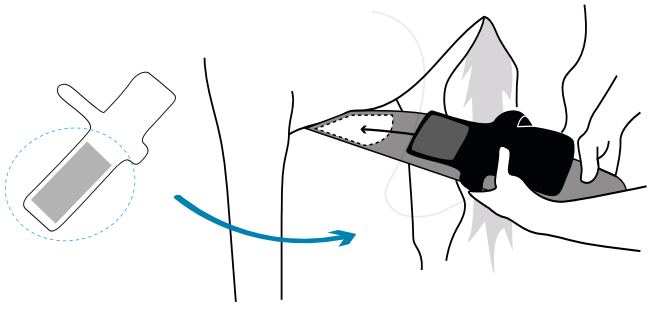

Place the sensor on the horse's girth, with the second electrode against the horse's skin.

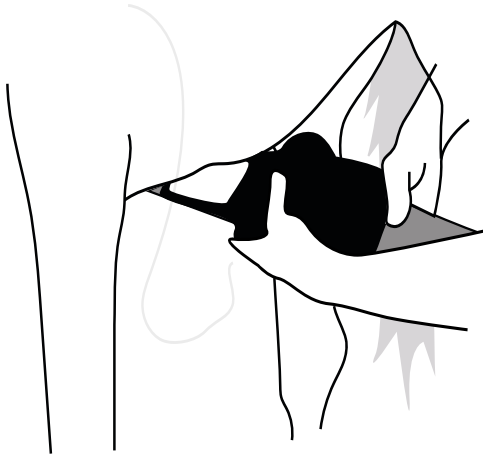

Slide your sensor no further than the middle of the abdomen, then fasten the sensor with the strap.

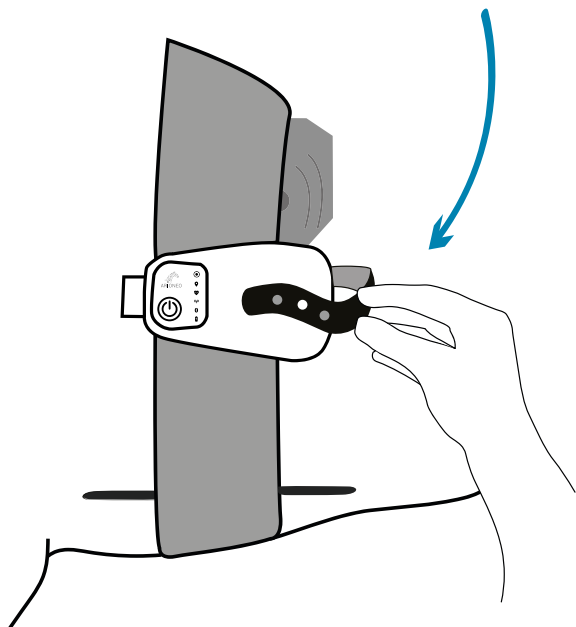

6 PUT THE CABLE BETWEEN THE CHIP READER AND THE GIRTH

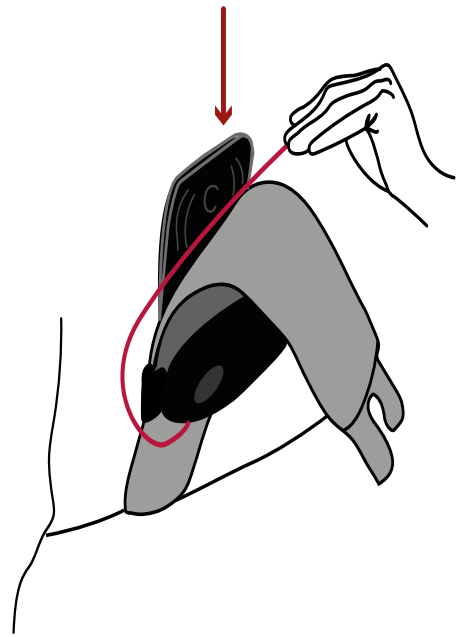

7 GENTLY TIGHTEN UP YOUR GIRTH



8 PUT THE REMAINING CABLE UNDER THE PAD

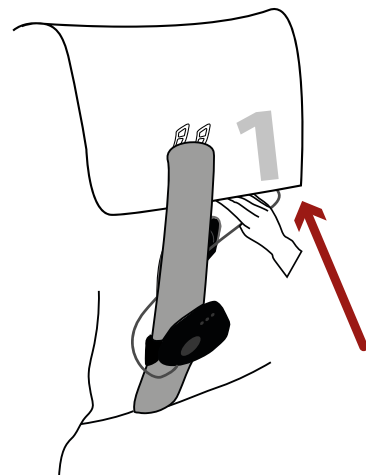

To avoid getting in the way of the rider's foot.

9 PUSH THE ELBOW OF THE SENSOR AGAINST THE GIRTH

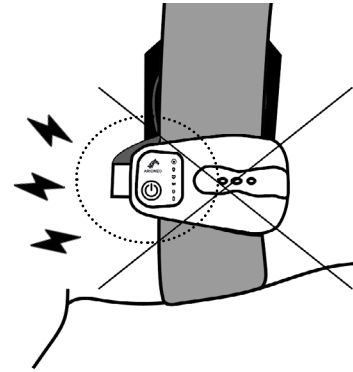
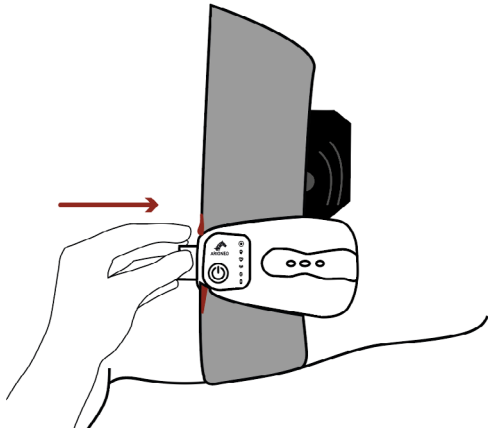

Otherwise the elbow may pinch / injure the horse during gallop.

10 MAKE SURE THE SENSOR IS PROPERLY SET UP

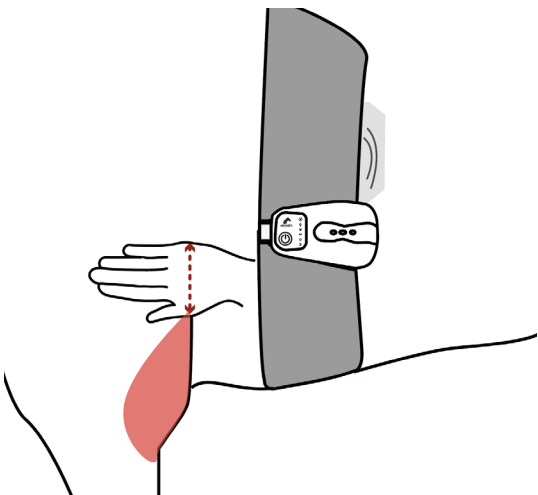

You should be able to put a hand horizontally between the sensor and the horse's elbow. This is a precaution to avoid friction during training.

11 CLOSE THE VELCRO AROUND THE GIRTH

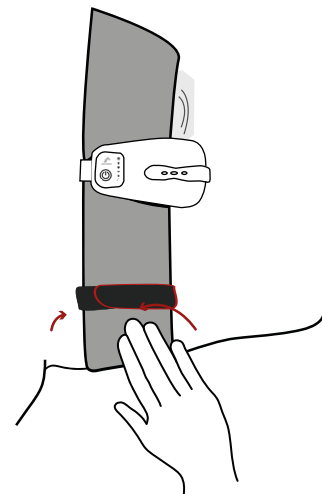

12 CHECK IF YOU'RE READY TO GO



The first white LED must be turned on and white.



The second green LED shows GPS and flashes until a signal is detected. When you are inside, it may flicker; when you are outdoors, it will stabilize.



The third red LED shows the heart rate. Once installed, the sensor should blink at your horse's heart rate.

13 YOU'RE GOOD TO GO IF

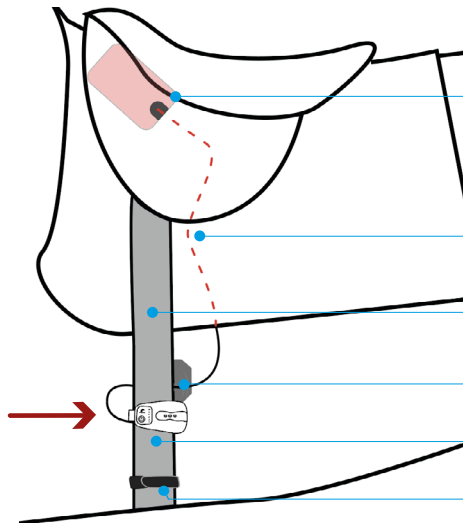

The withers electrode is humidified and in the withers hollow.

To avoid interfering with the rider's foot, the cable is hidden beneath the pad.

The girth is tightened to ensure good conductivity of the heart signal.

The cable is placed between the girth and the chip reader.

The elbow of the device is in contact with the girth.

The velcro are attached.

How to take the EQUIMETRE off?

At the end of your training, it is important to remove your EQUIMETRE by following the instructions below.

1 TURN THE EQUIMETRE OFF

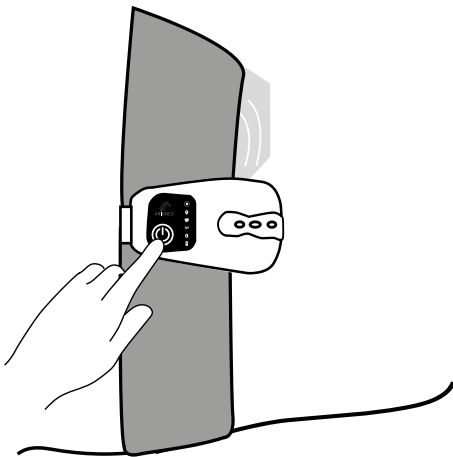

Turn the EQUIMETRE off by pressing the button during 3 seconds. All LEDs should turn off.

2 GRAB THE WITHERS ELECTRODE

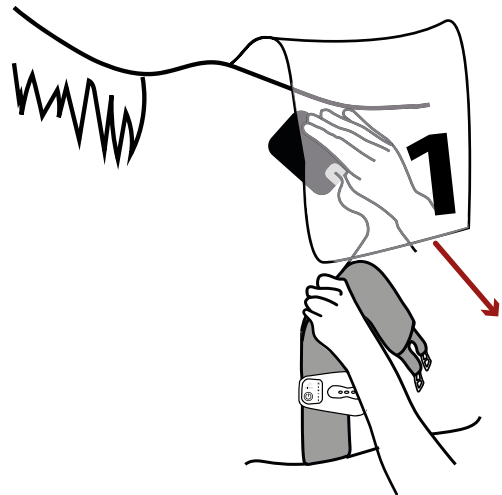

Warning : Do not pull on the electrode cable. You have to grab it with your hand under the saddle.

3 TAKE THE EQUIMETRE OFF THE GIRTH BEFORE UNSADDLING

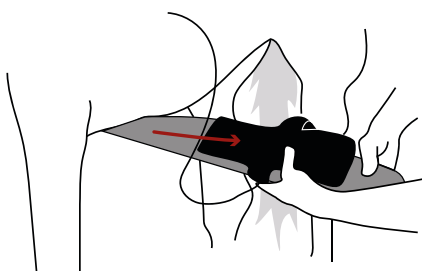

Untie the velcro and strap to remove the sensor.

4 CHARGE THE EQUIMETRE

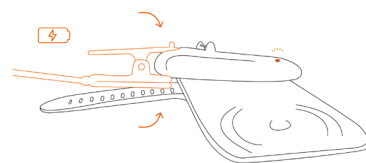

Warning : When not in use, be sure to always plug EQUIMETRE and check if the sensor is turned off. The charging orange LED should be on.

How to synchronise your data?

At the end of your training, access your data with your phone.

1 LOG IN TO THE EQUIMETRE APP

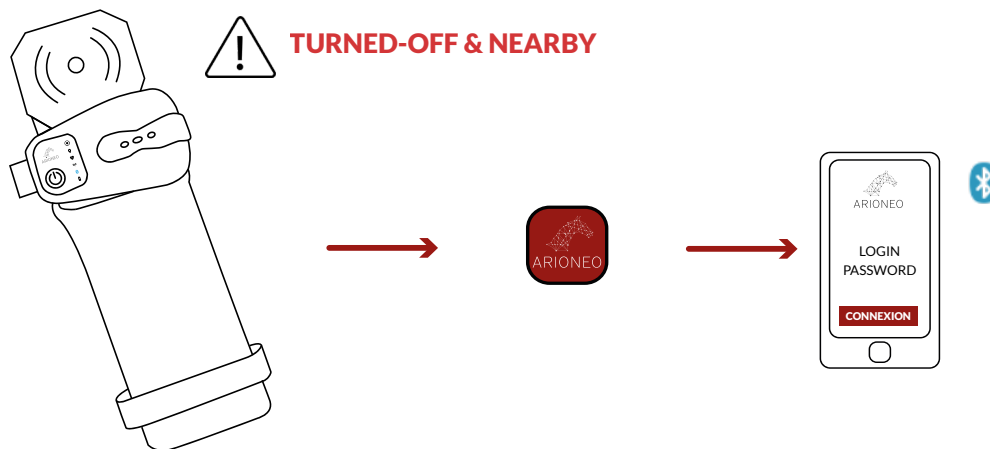

2 CLICK ON THE «SYNCHRONIZE» BUTTON

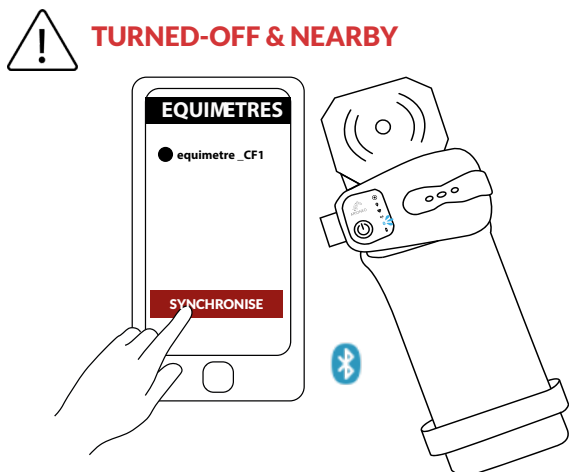

The download gauge reaches 100%. Equimetre must be turned off.

The bluetooth LED should start blinking. Your phone must be close to the sensor.

3 IN THE «TRAINING» TAB YOU WILL FIND THE LIST OF DOWNLOADED TRAINING SESSIONS

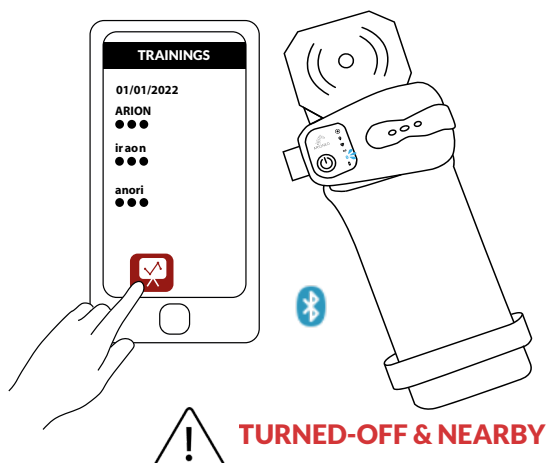

Trainings are automatically uploaded to the Cloud so you can find them from any device on Equimetre.com.

Click on the training to view it directly from the app.